



Fuels Safety Program	Ref. No.: FS – 136 - 08	Rev. No.:
ADVISORY	Date: July 15, 2008	Date:

Subject: Quietside Corp. – Unapproved Vent Adaptor for the QVM9 Series Instantaneous Water Heaters
Sent to: Quietside Corporation
Fuel Suppliers: Union Gas, Enbridge Gas, Kitchener Utilities, Kingston Utilities
Intertek – ETL Semko
Mattamy Homes
Direct Energy, Union Energy
Alliance Power Corporation
Morenergy Services Incorporated
Posted on TSSA Web-Site

This is a follow-up to the Director's Order FS-134-08 dated June 9, 2008. The director's order required the following:

1. The vent Adaptor used on the QUIETSIDe CORP. QVM9 Series Water Heater is not approved for use in Ontario. The following actions are required.
 - (a) No water heater shall be installed with this adaptor installed until it gets approved.
 - (b) Any water heater currently installed with this adaptor shall be retrofitted by an approved adaptor by September 15, 2008. Failure to comply will result in the termination of the fuel supply.

TSSA has received confirmation from Intertek Testing (ETL) that an adaptor is now approved and is part of the certification of the water heater.

Effectively immediately new water heaters may be installed with the approved adaptor. This shall be installed in accordance to the certified instructions.

All currently installed water heaters shall be retrofitted by September 15, 2008 with the approved adaptor and in accordance with the approved retrofit installation instruction's, see attached.



**QVM9 Vent Adaptor
Mechanical Solution**

7-10-2008

Securing Flue Pipe

- Check Vent adaptor and the exhaust vent connection
- Make sure groove in adaptor is snapped into the O ring factory installed in the vent connection



Securing Flue Pipe

- Drill 9/64" hole in 2 places through both adaptor and vent connection
- Drill holes 180° apart for maximum strength and locate vertically midway between O ring groove and top of vent connector
- Ensure no debris from drilling enters unit

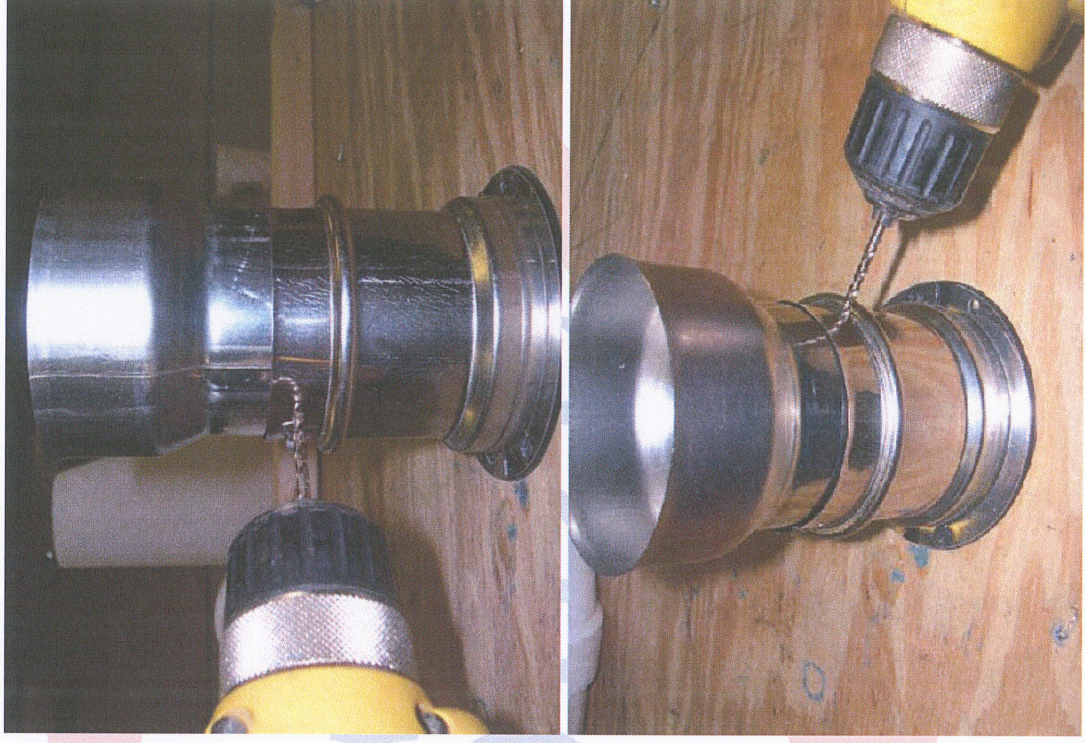

Securing Flue Pipe

- Insert 2 x #10 x 1/2" stainless screw (provided) into holes and tighten
- Caulk (provided) around and over screw to prevent leaks
- Caulk the joint face between vent connector and adaptor
- Wrap foil tape around joint, ensuring that screw heads are completely covered
- Allow Silicone to cure per manufacturers instructions



Securing Flue Pipe

- Ensure 3" CPVC pipe is inserted to shoulder of vent adaptor
- Locate hose clamp just below top of vent adaptor
- Tighten hose clamp to a complete stop of clamp screw



Securing Flue Pipe

- Caulk, using hi temp silicone (provided) joint of adaptor and CPVC to ensure a seal
- Wrap foil tape over joint and hose clam to prevent any additional leakage
- Allow Silicone to cure per manufacturers instructions before starting unit

